

# 摩托车链

## Motorcycle chains

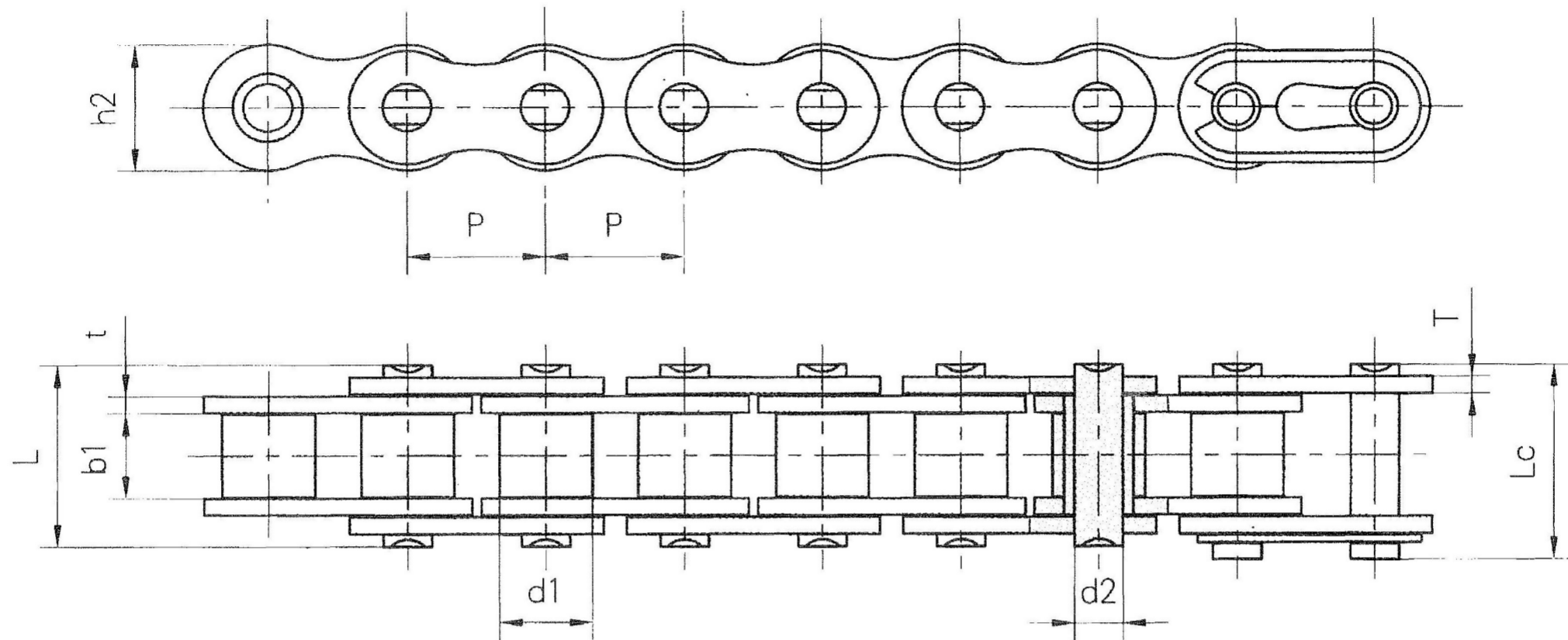

Chain No.	节距 Pitch P	滚子直径 Roller diameter d1	内节内宽 Width between inner plates b1	销轴直径 Pin diameter d2	销轴长度 Pin length L	内链板高度 Inner plate depth h2	链板厚度 Plate thickness t/T	极限拉伸载荷 Ultimate tensile strength Q	平均拉伸载荷 Average tensile strength Q <sub>0</sub>	每米长重 Weight per meter q
	mm	mm	mm	mm	mm	mm	mm	kN/LB	KN	kg/m
*25H	6.35	3.30	3.18	2.31	8.90	6.00	1.04	4.80/1091	5.5	0.17
*219H	7.774	4.59	5.00	3.01	11.90	7.40	1.2/1.04	6.60/1500	7.4	0.28
*270H	8.50	5.00	4.75	3.28	13.15	8.45	1.8/1.4	9.80/2227	11.0	0.33
*T3F	9.525	6.00	9.50	4.50	18.60	9.30	1.85/1.50	11.80/2682	14.1	0.61
415	12.70	7.77	4.76	3.60	11.0	9.70	1.00	6.86/1559	7.6	0.32
415H	12.70	7.77	4.76	3.96	13.1	12.00	1.50	14.40/3273	16.1	0.55
420	12.70	7.77	6.25	3.96	14.70	12.00	1.50	16.00/3636	18.1	0.55
428	12.70	8.51	7.75	4.45	16.70	11.80	1.60	18.0/4091	20.1	0.70
428H	12.70	8.51	<b>7.75</b>	4.45	18.80	11.80	2.03	20.60/4682	23.4	0.79
428DS	12.70	8.51	7.94	4.45	17.90	12.00	1.85	18.62/4232	21.0	0.76
520	15.875	10.16	6.25	5.08	17.50	15.09	2.03	26.50/6022	29.7	0.89
520H	15.875	10.16	6.25	5.08	19.30	15.09	2.42	26.50/6022	31.5	1.10
525	15.875	10.16	7.95	5.08	19.30	15.09	2.03	26.50/6022	29.9	1.06
525H	15.875	10.16	7.95	5.08	20.90	15.09	2.42	26.50/6022	29.9	1.20
530	15.875	10.16	9.40	5.08	20.70	15.09	2.03	26.50/6022	29.7	1.06
530SH	15.875	10.16	9.40	5.08	22.10	15.09	2.42	32.80/7379	33.5	1.24

\*套筒链：表中滚子直径d1为套筒直径

\*Bushing chain: d1 in the table indicate the external diameter of the bushing.